

PART NUMBER

**ITL-8**

**Installation Tools**

**BEFORE YOU BEGIN**

**PRIMARY APPLICATIONS**

> Designed specifically for installation of Heavy Duty SuperSprings

**PARTS LIST**

Item	Discription
A	Adjustable Pin Bolt, Retention Sleeve, & Compression Block Assembly
B	Side Rail Holes
C	Threaded Piston Extension
D	Hydraulic Ram Piston
E	Jacking Arm Bar
F	Side Plate Fastening Hardware
G	Hydraulic Ram Release Valve

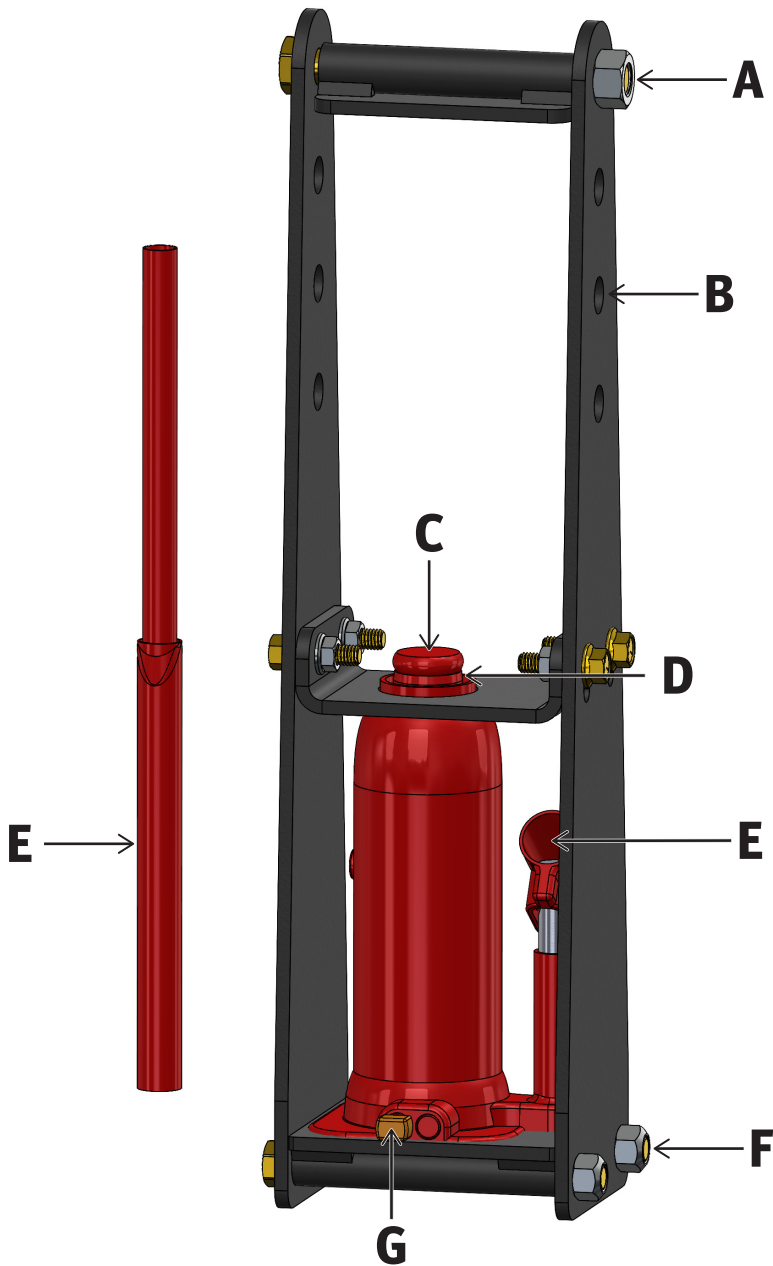

**Part Number: ITL-8**

**Product Line: INSTALLATION TOOLS**

**Page 1**

Questions or Concerns?

Scan here:



or visit:  
[superspringsinternational.com](http://superspringsinternational.com)

**SAFETY NOTICE:** We recommend installation be done by a professional or persons with sound mechanical knowledge.

**WARNING:** These instructions are a general guide for installation. SuperSprings International (SSI) assumes no liability for the actual installation process. Consumers and installers should apply common automotive safety practices when raising and working on any vehicle. **Do not put yourself in a position where, if the vehicle were to move unexpectedly, you may be injured.** SSI's products are designed to improve vehicle ride quality. Do not load any vehicle beyond the manufacturer's specifications.

Never exceed the manufacturer's Gross Vehicle Rating (GVWR) located on your vehicles identification tag.

**BEFORE INSTALLATION:** Ensure the vehicle is on a hard level surface, the parking brake is ON, with the ignition OFF, and place chocks in front of and behind the tires to prevent the vehicle from moving.

**DURING AND/OR AFTER INSTALLATION:** Ensure emergency brake cables are not touching the SSI products. Secure any cables out of the way with zip ties or by re-routing. Ensure all A/C lines, brake cables, and frame are clear of contact or interference.

REV. 2.01 | JUN 2024

PART NUMBER  
**ITL-8**

**Installation Tools**

**INSTALLATION**

1. Ensure all Side Plate Fastening Hardware [ITEM F] are tight.
2. Observe both the position of the Hydraulic Ram Piston [ITEM D] and the Threaded Piston Extension [ITEM C]. If either are over-extended, return them to their fully seated position.
3. With the Hydraulic Ram Release Valve [ITEM G] in a closed state (turned clock wise till firm), remove the Adjustable Pin Bolt and its Retention Sleeve & Compression Block [ITEM A] from its current hole position.
4. Once the SuperSpring is positioned on the vehicles spring pack and readied for compression, place the base of the ITL-8 under the intended location for its use (ideally this position is as close to the eye of the SuperSpring as possible) with its vertical side rails situated inboard and out board of the existing spring pack above.
5. Lift the ITL-8 into position, capturing the SuperSpring and existing factory leaf pack (NOTE: This requires supporting the entire 30 lb weight of the tool for a length of time) and install the Pin Bolt, Retention Sleeve, and Compression Block Assembly [ITEM A] into the lowest hole as possible above the SuperSpring blade and tighten its retaining fastener.
6. Rotate the Threaded Piston Extension [ITEM C] to remove any extra space.
7. Ensure the Pin Bolt, Retention Sleeve, and Compression Block Assembly [ITEM A] has the flat portion facing the SuperSpring. Using the Jacking Arm Bar [ITEM E] compress the SuperSpring downward until the spring is compressed enough to enable the SuperSpring Roller Bolt Assembly to be installed at the desired Shackle Hole.
8. To remove the ITL-8 from the installed SuperSpring, turn the Hydraulic Bleed Screw [ITEM H] counter clockwise slowly to release tension then complete all the above steps in reverse.
9. It's suggested to store the tool with the Hydraulic Ram Piston [ITEM D] and Threaded Piston Extension [ITEM C] in their retracted state with the jacks Hydraulic Ram Release Valve [ITEM G] closed.
10. As with any hydraulic jack it maybe necessary to add jack oil periodically to maintain performance. It's not recommended to change or replace tool hardware. If any portion of the tool is observed to be damaged or deformed from use refrain from further use and contact SuperSprings International.

**NOTE:** This product contains hydraulic fluid, incase of spill use absorbent granules to clean up. Incase of skin or clothing contact, use soap and water to wash off.

**Part Number: ITL-8**

**Product Line: INSTALLATION TOOLS**

**Page 2**

Questions or Concerns?

Scan here:



or visit:  
superspringsinternational.com

**SAFETY NOTICE:** We recommend installation be done by a professional or persons with sound mechanical knowledge.

**WARNING:** These instructions are a general guide for installation. SuperSprings International (SSI) assumes no liability for the actual installation process. Consumers and installers should apply common automotive safety practices when raising and working on any vehicle. **Do not put yourself in a position where, if the vehicle were to move unexpectedly, you may be injured.** SSI's products are designed to improve vehicle ride quality. Do not load any vehicle beyond the manufacturer's specifications.

**Never exceed the manufacturer's Gross Vehicle Rating (GVWR) located on your vehicles identification tag.**

**BEFORE INSTALLATION:** Ensure the vehicle is on a hard level surface, the parking brake is ON, with the ignition OFF, and place chocks in front of and behind the tires to prevent the vehicle from moving.

**DURING AND/OR AFTER INSTALLATION:** Ensure emergency brake cables are not touching the SSI products. Secure any cables out of the way with zip ties or by re-routing. Ensure all A/C lines, brake cables, and frame are clear of contact or interference.

**REV. 2.01 | JUN 2024**