

PART NUMBER

CSS-1069



PRODUCT INFORMATION



PRODUCT LINE
Coil SumoSprings

COLOR
Black

BOX INFORMATION

SHIPPING DIMENSIONS



BOX DESCRIPTION
Small SumoSpring Box

BOX NUMBER
512502

TAPE MACHINE POSITION
#18 // 16" (40.64cm)

BILL OF MATERIALS

Item	Part #	Discription	QTY
A	511462	Coil SumoSprings	2
B	512502	Small SumoSpring Box	1
C	122342	Sticker Pack	1
D	INS_CSS-1069	Install Guide for CSS-1069	1

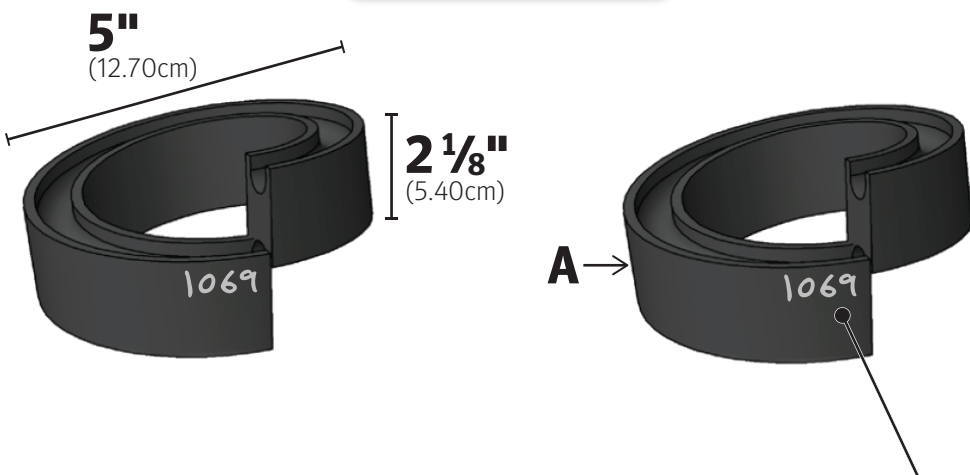
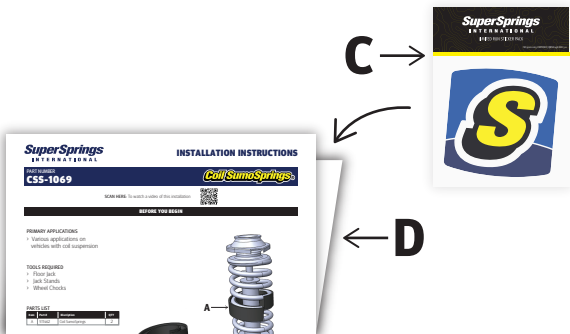

TOOLS REQUIRED

- › Protective gloves
- › Safety glasses
- › Permanent silver marker
- › Metal ruler
- › Microfiber towel
- › Protectant cleaner

BEFORE YOU BEGIN

PLEASE NOTE

The following step that is highlighted in yellow requires you to wear protective gloves and safety glasses to complete.

PART NUMBER INDICATION

Double check that the part number, **1069**, is written on top of the component. If not, remove from assembly and notify the Lead associate for QC inspection. If part number is correct, the Lead or warehouse associate shall write the number on top with a permanent silver marker.

PACKING INSTRUCTIONS

1. Print or retrieve one set of installation instructions per kit. Always use the current, approved, document revision.
2. Fold instructions in half and place the sticker pack within the folded document. Set them aside.
3. Locate and review components needed to build kit as listed in the Bill of Materials section.
4. Start by building the kit box according to the Box Guide.
5. Visually inspect the height of the two Coil SumoSprings, and ensure they match each other. If not, select another component until both match in height. If needed, use the metal ruler for assistance with accuracy.
6. Using a microfiber towel and a small amount of protectant cleaner, wipe clean the Coil SumoSprings of any dust or debris.
7. Intersect both Coil SumoSprings so that the components are facing sideways (refer to diagram below) and place components in the empty box.

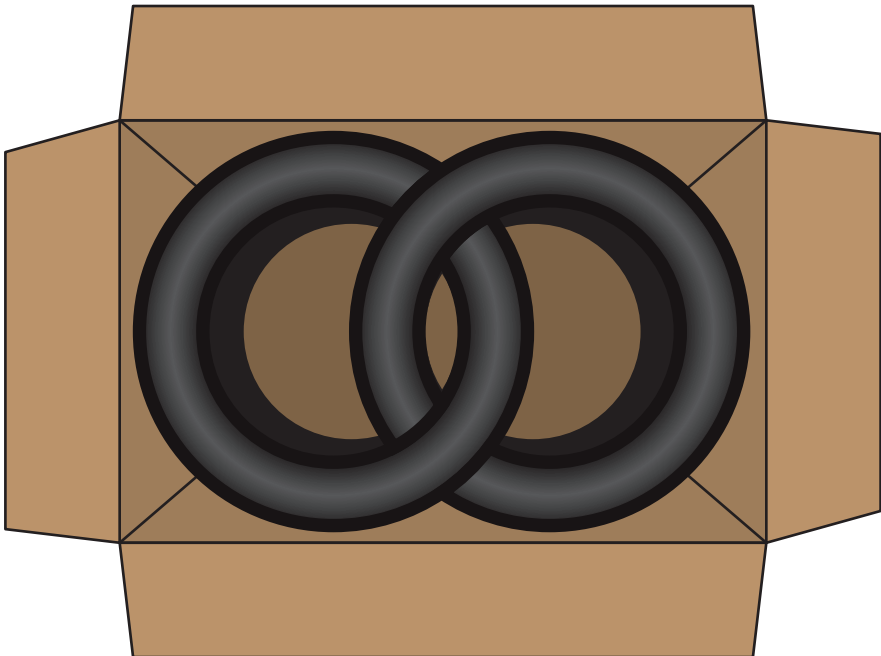

8. Retrieve the installation instructions packet, which should contain the sticker pack, and place it on top of the components in the box.
9. Close the top of the box by completing the steps referenced in the Box Guide.
10. Using the scanner (refer to scanner instructions) print out a label.
11. Position label vertically, on the left side of the end of the box with the SuperSprings International logo side to the left (refer to Completed Kit Diagram).
12. Place the finished kit in the applicable bin.

COMPLETED KIT



COMPLETED KIT WEIGHT
2lbs (0.91kg)